

# Sheaves

## 12C/QD STYLE

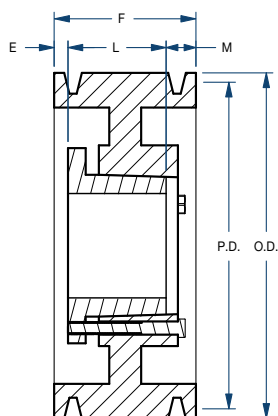
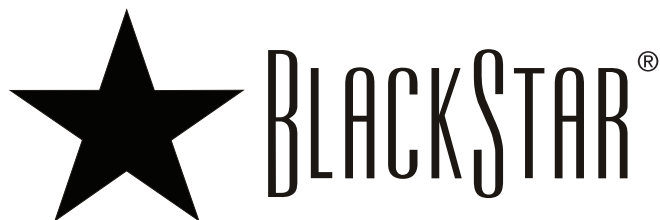

Type A

Part No.	Bushing	Bore Range (in)	Type	Diameter (in)		Dimensions (in)				Weight less Bushing (lbs)
				Pitch	Outside	E	F	L	M	
12C90J	J	1-1/2 – 4-1/2	A	9.0	9.40	2-9/16	12-1/4	4-5/8	5-1/16	80.0
12C95J	J	1-1/2 – 4-1/2	A	9.5	9.90	2-9/16	12-1/4	4-5/8	5-1/16	88.0
12C100J	J	1-1/2 – 4-1/2	A	10.0	10.40	2-9/16	12-1/4	4-5/8	5-1/16	95.0
12C105J	J	1-1/2 – 4-1/2	A	10.5	10.90	2-9/16	12-1/4	4-5/8	5-1/16	101.0
12C110J	J	1-1/2 – 4-1/2	A	11.0	11.40	2-9/16	12-1/4	4-5/8	5-1/16	111.0
12C120J	J	1-1/2 – 4-1/2	A	12.0	12.40	2-9/16	12-1/4	4-5/8	5-1/16	127.0
12C130J	J	1-1/2 – 4-1/2	A	13.0	13.40	2-9/16	12-1/4	4-5/8	5-1/16	137.0
12C140J	J	1-1/2 – 4-1/2	A	14.0	14.40	2-9/16	12-1/4	4-5/8	5-1/16	150.0
12C160J	J	1-1/2 – 4-1/2	A	16.0	16.40	2-9/16	12-1/4	4-5/8	5-1/16	170.0
12C180J	J	1-1/2 – 4-1/2	A	18.0	18.40	2-9/16	12-1/4	4-5/8	5-1/16	205.0
12C200M	M	2 – 5-1/2	A	20.0	20.40	9/32	12-1/4	6-3/4	5-7/32	245.0
12C240M	M	2 – 5-1/2	A	24.0	24.40	9/32	12-1/4	6-3/4	5-7/32	285.0
12C300M	M	2 – 5-1/2	A	30.0	30.40	9/32	12-1/4	6-3/4	5-7/32	355.0
12C360M	M	2 – 5-1/2	A	36.0	36.40	9/32	12-1/4	6-3/4	5-7/32	420.0
12C440M	M	2 – 5-1/2	A	44.0	44.40	9/32	12-1/4	6-3/4	5-7/32	515.0
12C500M	M	2 – 5-1/2	A	50.0	50.40	9/32	12-1/4	6-3/4	5-7/32	575.0